

LTG002

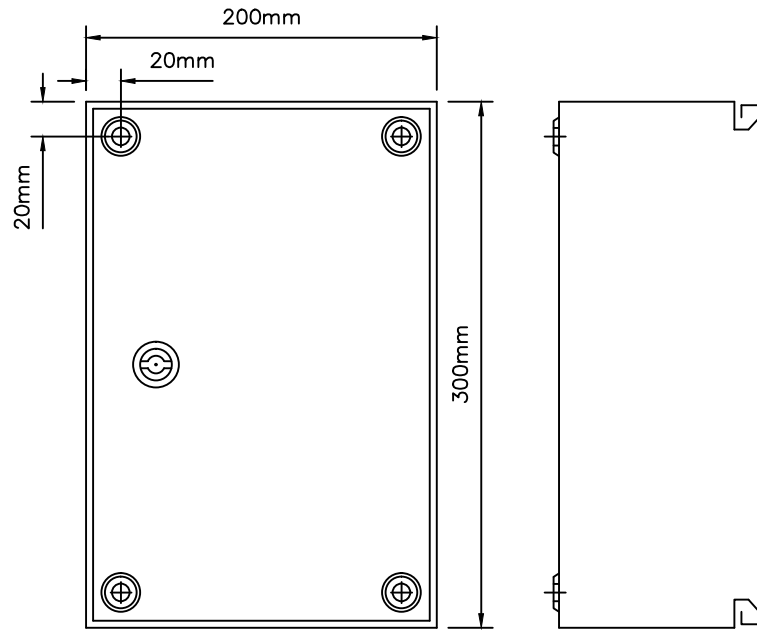

NOTES

FINISH: – ELECTROPHORESIS DIP PRIMED PLUS ADDITIONAL TOP COAT GREY FACTORY FINISH. ADDITIONAL ONE COAT OF ZINC PHOSPHATE (GREY) AND TOP COAT OF GLOSS BS 4800 COLOUR TO ALL EXTERNAL SURFACES PRIOR TO INSTALLATION. BOX TO BE SUPPLIED WITH BACKBOARD AND PLAIN CABLE ENTRY PLATE WITH ALL FIXING SCREWS. DOOR TO HINGE LEFT OR RIGHT HANDED. I.P. RATING 55.

All Dimensions in millimetres unless otherwise stated

REV	DETAILS	BY	DATE

**WALL MOUNTED SUPPLY UNIT**

Date : March 2017	Drawn by : R. Hoggan
Scale : N.T.S.	Checked by : K. Slight

**Drg. No. LTG002**

LIGHTING STANDARD  
DRAWING